

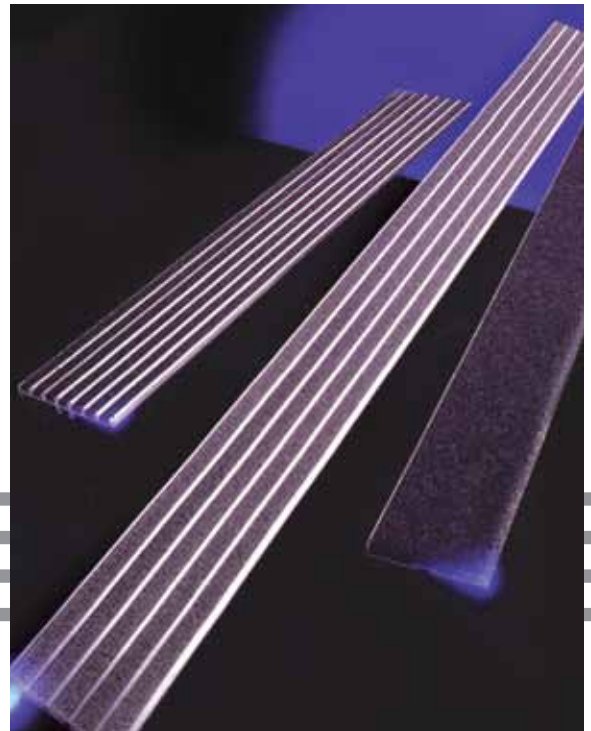

Stair Nosing



SINGLE COMPONENT NOSINGS

TWO COMPONENT NOSINGS

BRONZE NOSINGS

RETROFIT NOSINGS

PHOTOLUMINESCENT NOSINGS

NON-SLIP ABRASIVE BARS

CAST ALUMINUM NOSINGS

CAST IRON NOSINGS

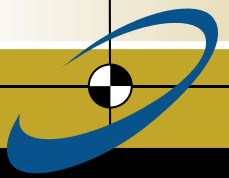

Stair Nosings

TABLE OF CONTENTS

- 2 Single Component
- 3 Two Component
- 3 Arch Bronze
- 3 Retrofit
- 4-5 Photoluminescent Stair Nosing
- 6 Non-Slip Abrasive Bars
- 7 Color Selector

Balco has supplied quality stair nosing products to the construction trade for over 25 years.

And now, our new IllumiTread™ line of photoluminescent stair nosing and egress marking products will provide a safe and reliable exit path in the event of a power failure.

Whether new construction or renovation, Balco has the right solutions for all of your stair nosing and emergency egress needs.

www.balcousa.com
800-767-0082

SINGLE COMPONENT

P-200

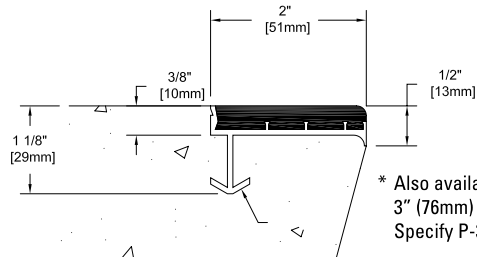

* Also available in 3" (76mm) and 4" (102mm) Specify P-300 and P-400

R-300

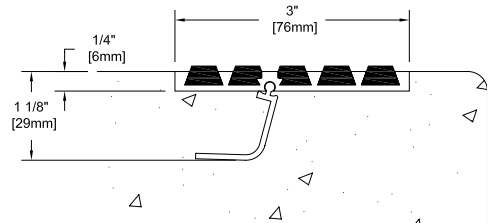

* Also available in 1 3/8" (35mm) Specify PC-150

H-10

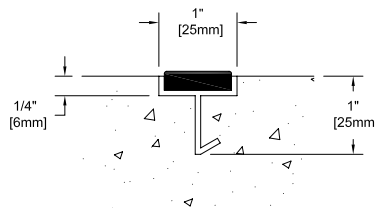

**R-315LP

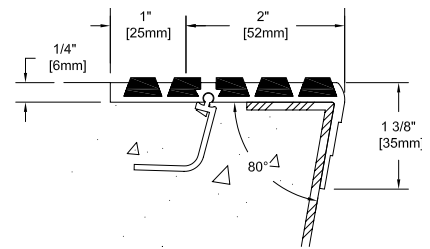

H-225

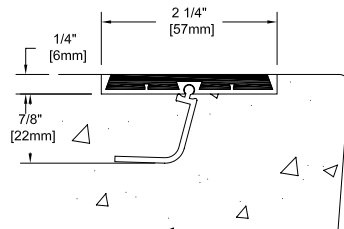

**R-315P

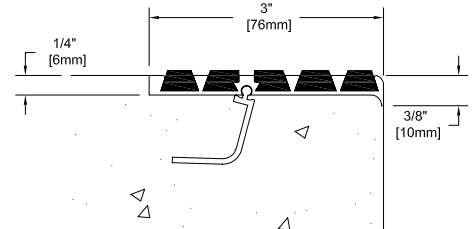

HS-338

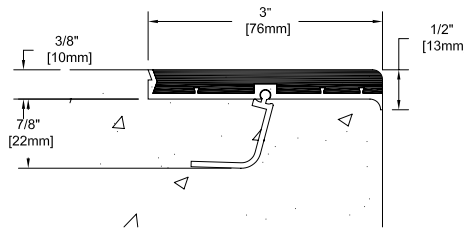

T-417

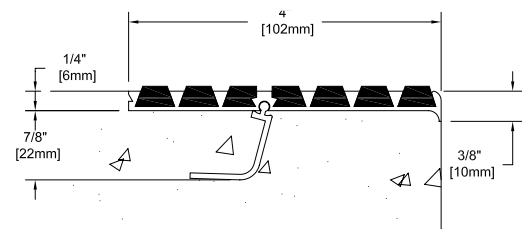

* Also available in 2" (51mm) Specify T-213

R-315 PC

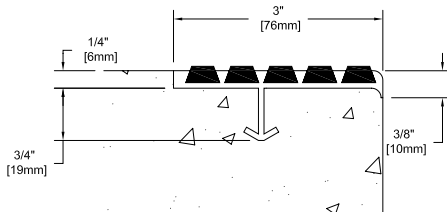

SANTOPRENE TREAD INSERTS

Exclusive field replaceable santoprene inserts with hidden fasteners.

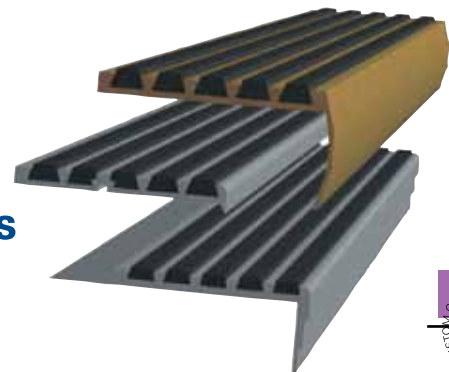

{DOWNLOAD CADs and pdfs}

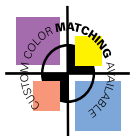

TWO COMPONENT

DXH-330

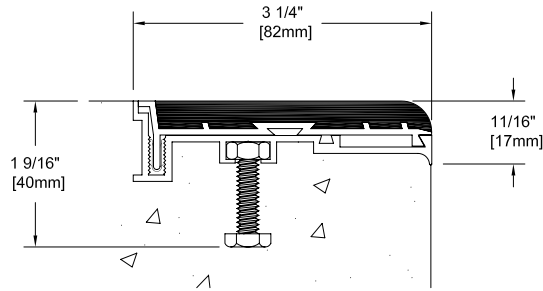

XH-330

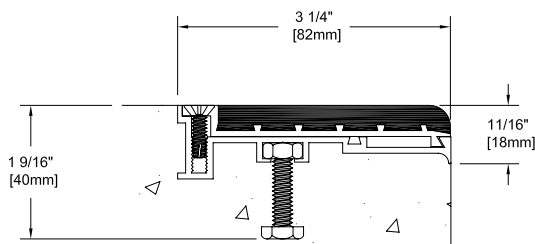

DST-330

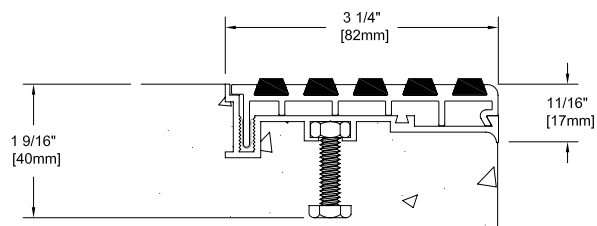

RETROFIT

**RS-405L

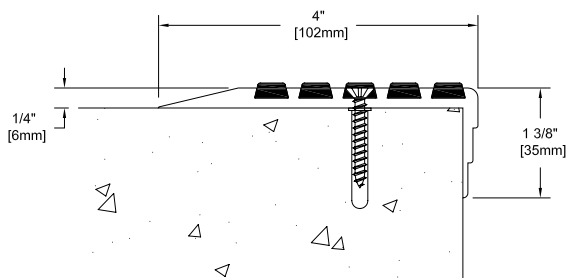

**RS-913L

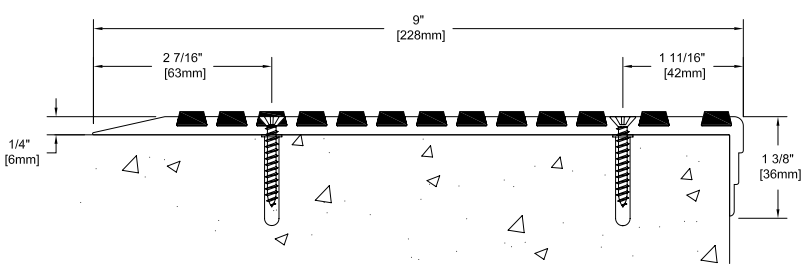

** Optional Black Santoprene treads available

ARCHITECTURAL BRONZE

Specify Type 5, Type 7 or Type 8 Anchors (see page 6).

**BT-400L

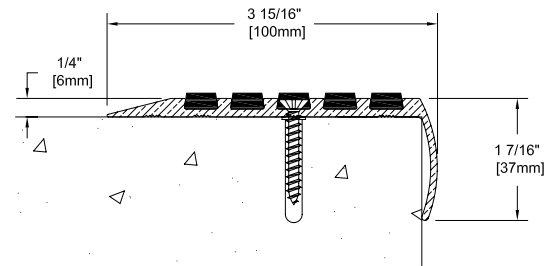

**BT-300L

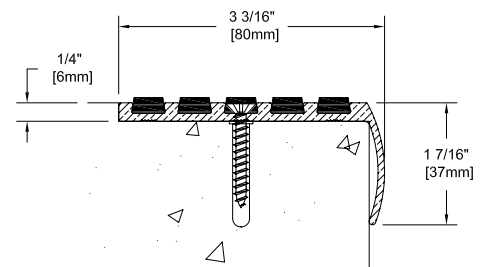

**BT-175

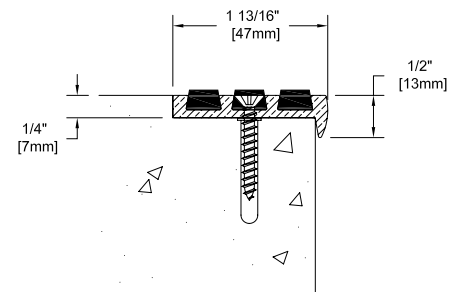

RETROFIT BEVELED EDGE - Optional (Additional Charge)

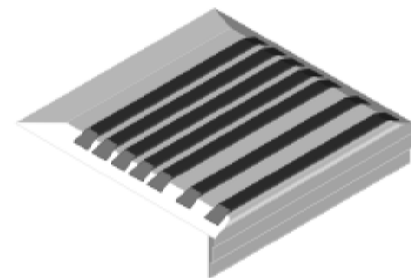

Also available in
6" (152mm)
9" (229mm)
11" (279mm)

Specify Type 5, Type 7 or Type 8 Anchors (see page 6).
All Treads are Shipped in 10'-0" Maximum Lengths.

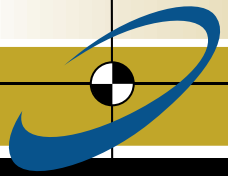

Illumitread™ Photoluminescent Stair Nosing Products

PHOTOLUMINESCENT NOSINGS

2140
ILLUMITREAD™ RETROFIT STAIR NOSING
Mill Finish Aluminum Extrusion
Maximum Length 10' (3048 mm)
W/ 1/2" Photoluminescent Insert

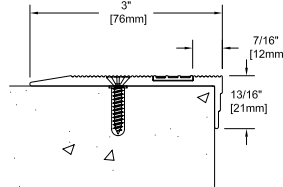

4199
ILLUMITREAD™ RETROFIT STAIR NOSING
Mill Finish Aluminum Extrusion
Maximum Length 10' (3048 mm)
W/ 1" Photoluminescent Insert

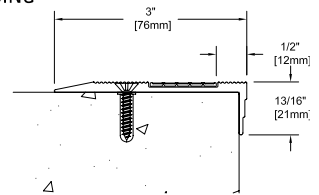

R-315P-PL
ILLUMITREAD™ STAIR NOSING
Mill Finish Aluminum Extrusion
Maximum Length 10'-0" (3048mm)
W/ 1/2" Photoluminescent Insert

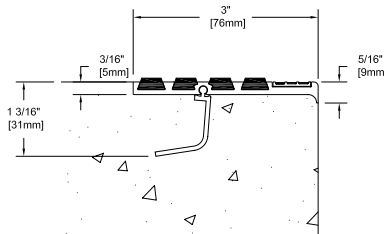

RS-405L-PL
ILLUMITREAD™ RETROFIT STAIR NOSING
Mill Finish Aluminum Extrusion
Maximum length 10'-0" (3048mm)
W/ 1/2" Photoluminescent Insert

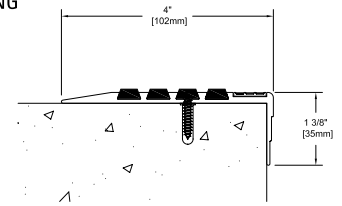

DXH-330-PL
ILLUMITREAD™ STAIR NOSING
TWO COMPONENT STAIR NOSING
Mill Finish Aluminum
Maximum Length 10'-0" (3048mm)
W/ 1/2" Photoluminescent Insert

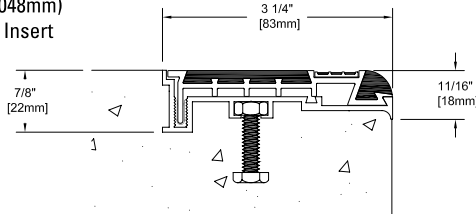

RS-609L-PL
ILLUMITREAD™ RETROFIT STAIR NOSING
Mill Finish Aluminum Extrusion
Maximum Length 10'-0" (3048mm)
W/ 1/2" Photoluminescent Insert

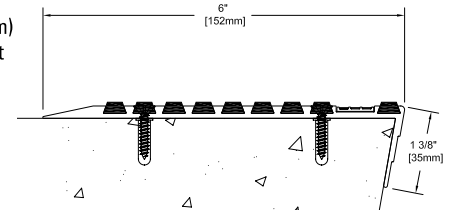

XH-330-PL
ILLUMITREAD™ STAIR NOSING
TWO COMPONENT STAIR NOSING
Mill Finish Aluminum
Maximum Length 10'-0" (3048mm)
W/ 1/2" Photoluminescent Insert

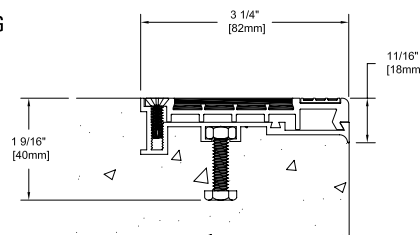

PHOTOLUMINESCENT NOSINGS

P-3310-PL-100

ILLUMITREAD™ STAIR NOSING
Mill Finish Aluminum Extrusion
Maximum Length 10'-0" (3048mm)
W/ 1" Photoluminescent Insert

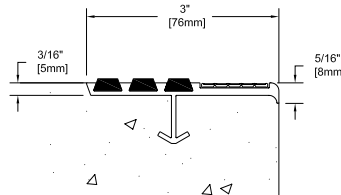

Benefits

Exceeds New York City RS 6-1 and RS 6-1A
Brightness Rating Requirements
1" Models = BR: 41-10-7
1/2" Models = BR: 106-29-20
BR = Brightness Rating after 10 minutes-60 minutes-
90 minutes

MEA-243-05M VOL. II

Highly durable and built for permanent installation
inside or outside. UV stable

Easy, permanent installation

Easy clean - no other maintenance required

Non-flammable (fire resistant)

Non-toxic

Not Radioactive

Technical

Passes RS 6-1 Illuminance Test ISO 17398
(NYC minimum BR: 30-8-5)
Passes ASTM E2072-1 FC charging for 1 hour
Meets ICC-ES AC169

Passes UL 1994

Passed Weatherometer (2000 hour ASTM G155) and
Salt Spray (ASTM B117) tests

Passes RS 6-1 cleaning test – ASTM D 4828 –
RESULT 10 (no residual soiling or staining –
highest possible score, minimum required,
requirement – 5)

Passes RS 6-1 flame spread test – ASTM D 635

Passes RS 6-1 toxicity test – Bombardier SMP800-C

Passes RS 6-1 radioactivity tests ASTM D3648

RS-405L-PL-100

ILLUMITREAD™ RETROFIT STAIR NOSING
Mill Finish Aluminum Extrusion
Maximum Length 10'-0" (3048mm)
W/ 1" Photoluminescent Insert

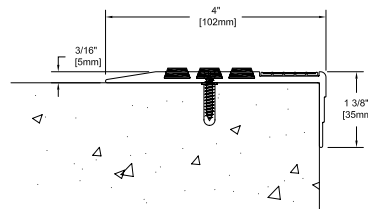

R-315P-PL-100

ILLUMITREAD™ STAIR NOSING
Mill Finish Aluminum Extrusion
Maximum Length 10'-0" (3048mm)
W/ 1" Photoluminescent Insert

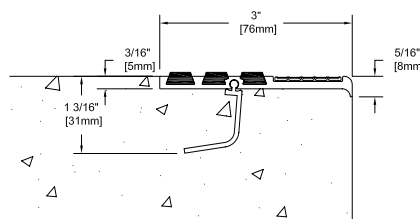

DXH-330-PL-100

ILLUMITREAD™ TWO COMPONENT STAIR NOSING
Mill Finish Aluminum Extrusion
Maximum Length 10'-0" (3048mm)
W/ 1" Photoluminescent Insert

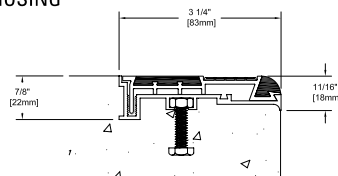

NON-SLIP ABRASIVE BARS

*Non-Slip Abrasive Bars are set in mastic, by others

AS-2

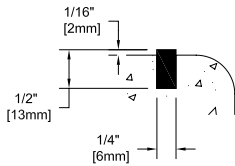

* Also Available:
AS-3 - 3/8" (10mm) Wide
AS-4 - 1/2" (13mm) Wide

Abrasive bars are shipped in 4' maximum lengths

ANB-1

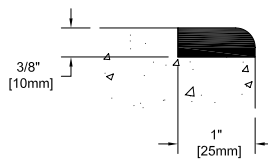

* Also Available:
ANB-2 - 2" (51mm) Wide
ANB-3 - 3" (76mm) Wide

AB-1

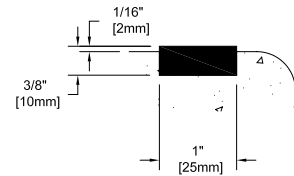

* Also Available:
AB-2 - 2" (51mm) Wide
AB-3 - 3" (76mm) Wide

CAST ALUMINUM/CAST IRON

CA-150L (Aluminum) CF-150L (Iron)

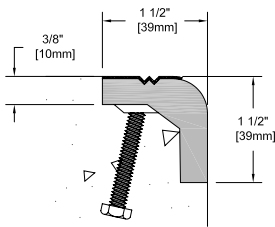

* Also Available in 2 1/2" (63mm) - Specify CA-250L or CF250L
Maximum length 4'6"

CA-200 (Aluminum) CF-200 (Iron)

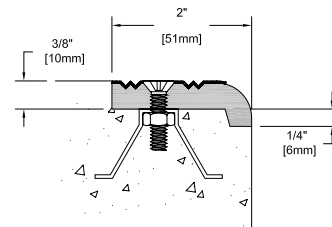

*Also available in 3" and 4"
CA-300/400
CF-300/400
Maximum length 5'

ANCHORS

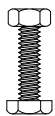

Type 1
Cast-In

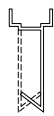

Type 2
Barbed



Type 3
Continuous

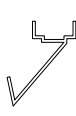

Type 4
Strap



Type 5
Wood Screw



Type 6
Ball Anchor



Type 7
Concrete Anchor

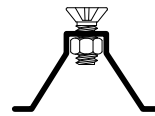

Type 8
Wing Anchor

- Types 1, 2, 3 and 4 are used with Two Component nosings exclusively; Types 2 and 4 are 1" (25mm) wide at 12" (305mm) O.C.
- Types 5, 7 and 8 are available for most Single Component and all Bronze nosings
- Types 5 and 7 are available for all Retro-fit nosings
- Type 6 is standard for all applicable Single Component nosings
- Type 6 is standard 1" (25mm) wide at 12" (305mm) O.C.; Type 6 is available as continuous at an additional charge — Please specify

All anchors are provided at 3" (76mm) from each end and 12" (305mm) O.C. unless noted as continuous

ABRASIVE COLOR SELECTIONS



earth brown



yellow



silver gray



redwood



black



terra cotta



Saf-T-Glo™ II
yellow-photoluminescent
(additional charge)



cactus green

ANODIZED COLOR SELECTIONS



clear



black



dark bronze



medium bronze



light bronze



gold



champagne

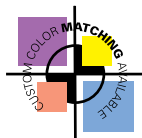

Quality products engineered and crafted to meet tomorrow's needs today... Over 50 years in the business is proof that we stand behind those words. Balco has set an industry benchmark with our combination of highly skilled engineers, manufacturing processes, and drafting designs. We customize our products to fit your projects' needs. At Balco, we're dedicated to bringing you the highest quality products at competitive prices. Let us be an integral part of your next project.

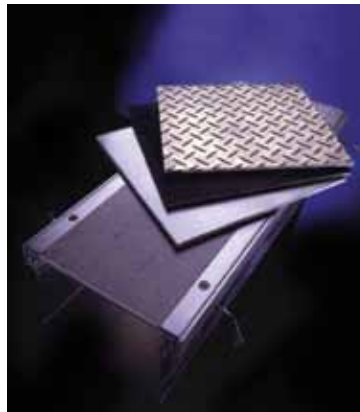

TRENCH & ACCESS COVERS

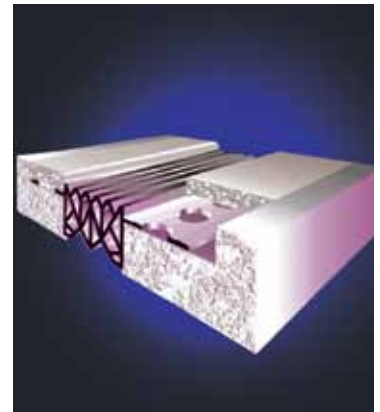

EXTERIOR EXPANSION JOINT SEALS

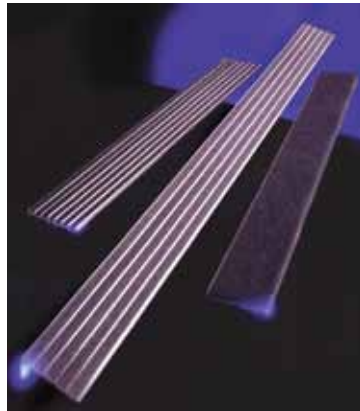

STAIR NOSINGS



EXPANSION JOINT COVERS

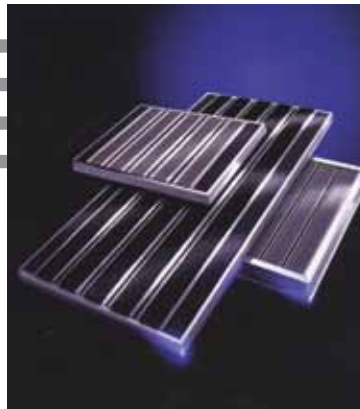

ENTRANCE MATTING SYSTEMS

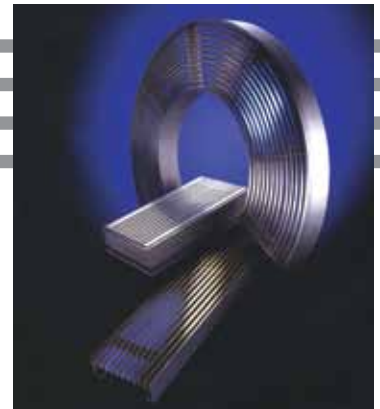

GRATES & FRAMES

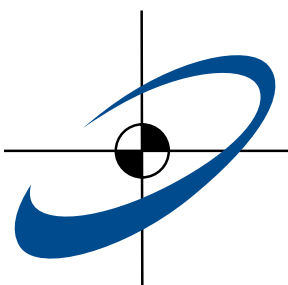

BALCO INC

1.800.767.0082 www.balcousa.com

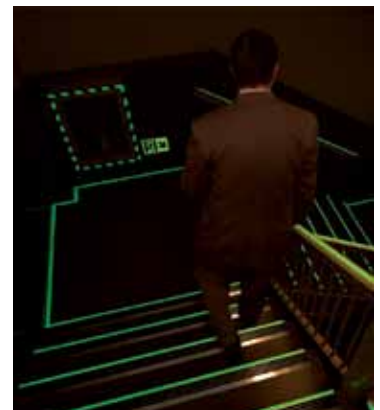

PHOTOLUMINESCENT

ISO 9001 **CERTIFIED**